



WELCOME TO KENSINGTON PALACE

We hope you enjoy your visit to this wonderful building, which has been a royal home since 1689.

The palace is divided into two halves – public rooms including the Queen’s and King’s State Apartments, which you can visit and uncover the public and private stories of the young royal families that have lived here, and a separate, private side where members of the Royal Family live today.

You can choose to visit the exhibitions in any order.

Don’t miss the beautiful Sunken Garden, featuring the statue of Diana, Princess of Wales, unveiled in July 2021.

We now have a Digital Visitor Guide with audio tours of the King’s State Apartments, Queen’s State Apartments and Victoria: A Royal Childhood available in multiple languages, including British Sign Language.

Please ask a member of staff if you require any assistance or have any questions about your visit today.

THE PALACE AND GARDENS

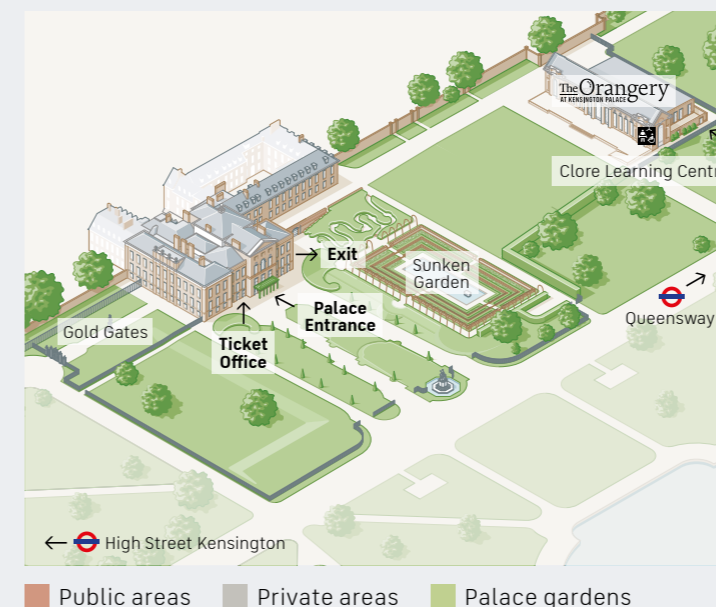

DISCOVER 300 YEARS OF ROYAL HISTORY

All routes are located on the upper floors and marked with different colours as shown on the drawing opposite.

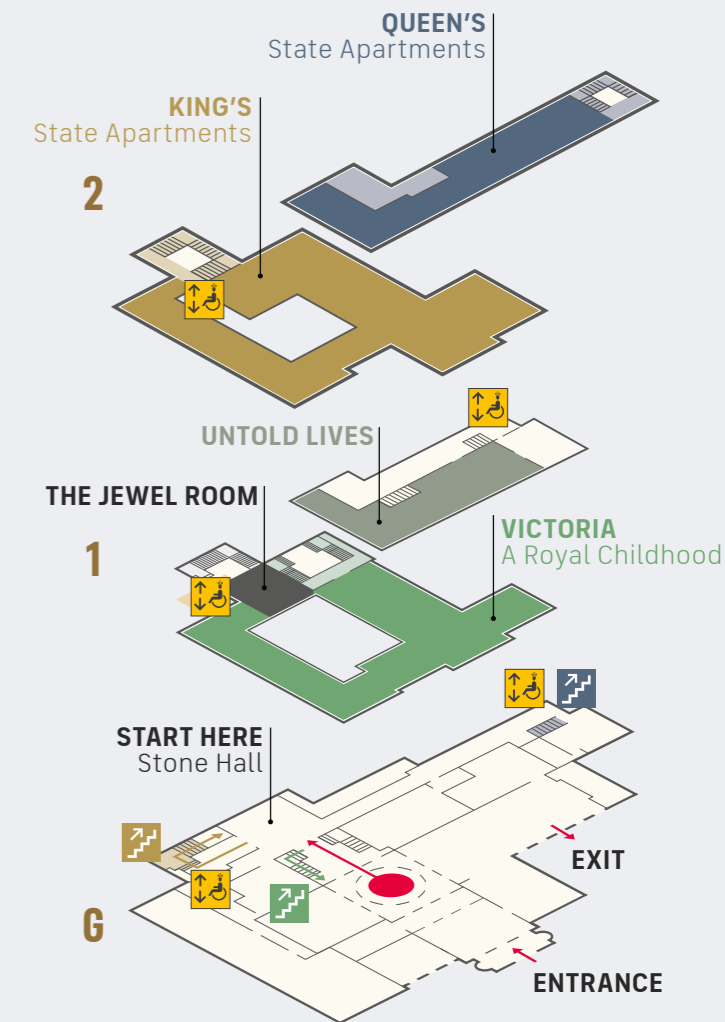

YOUR ROUTE STARTS IN THE STONE HALL

MAP KEY

- Tickets
- The Hub
- Shop
- Male toilet
- Female toilet
- Accessible toilet
- Baby change
- Stairs
- Lift
- Palace Café

Stairs to

- VICTORIA A Royal Childhood
- UNTOLD LIVES
- QUEEN'S State Apartments
- KING'S State Apartments
- THE JEWEL ROOM

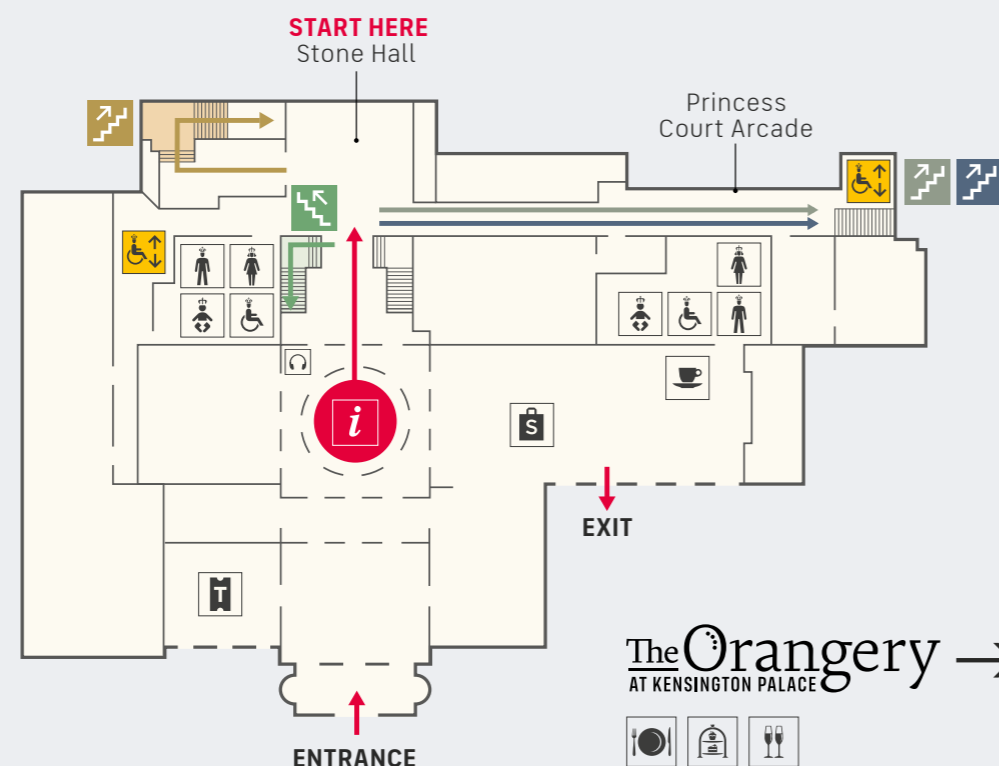

The Orangery →
AT KENSINGTON PALACE



The Orangery restaurant and tea room is open for delicious breakfasts, light lunches and elegant teas.

REMEMBER

PLEASE DO

Take photographs but no flash, video, 3D or panoramic photography/filming

Use bicycle racks outside the palace

PLEASE DO NOT

Touch objects or artworks on display

Eat or drink in the palace

Use selfie sticks or tripods in the palace

OPENING TIMES

Summer (1 March – 31 October)

10:00–18:00 (last entry 17:00)

Winter (1 November – 28 February)

10:00–16:00 (last entry 15:00)

ACCESSIBILITY

We have a number of manual wheelchairs available to use free of charge on a first come first served basis. These are for indoor use only.

Our team are here to help you make the most of your visit. Please ask if you require any assistance.

We have folding stools available to use free of charge, these are located after the scanner desk

BECOME A MEMBER TODAY

Save on unlimited adventures with free entry to Kensington Palace, the Tower of London, Hampton Court Palace, and Hillsborough Castle and Gardens. Prices start from £55 by Direct Debit.

Upgrade your eligible tickets to membership within two weeks of your visit. Join onsite or online at hrp.org.uk/membership or scan the QR Code.



SUPPORT US

Historic Royal Palaces is in an independent charity, who love and look after six of the most wonderful palaces in the world. We raise all our own funds to create accessible and engaging experiences across our palaces, for everyone.

Text PALACE to 70085 to donate £5 today, and help keep the spirit of the palaces alive for the future. Thank you.

Texts costs £5 plus one standard rate message.

Visit our website for more information hrp.org.uk

- [kensingtonpalace](https://www.facebook.com/kensingtonpalace)
- [historicroyalpalaces](https://www.instagram.com/historicroyalpalaces)
- [@hrp_palaces](https://twitter.com/hrp_palaces)
- [#kensingtonpalace](https://twitter.com/hashtag/kensingtonpalace)



VICTORIA A ROYAL CHILDHOOD

Queen Victoria, 1800s

Experience Queen Victoria's childhood apartments and the vibrant rooms where she was born and grew up. Witness her extraordinary story of teenage survival, amidst family feuds and tragedy, right up to the day she became Queen.

History where it happened

7 The Baby in The Palace

Queen Victoria was born in this room on 24 May 1819. Her parents, the Duke and Duchess of Kent, travelled over from Germany at the last minute so that their daughter would be born in England. After her safe arrival, the Duchess of Kent declared that baby Victoria was 'a pretty little Princess, plump as a partridge.'



KING'S STATE APARTMENTS

The Georgians, 1700s

Explore the glittering court of George II and his wife Queen Caroline and discover the era of music, fashion and the arts brought to life in the splendid and sumptuously restored State Apartments.

History where it happened

2 The Presence chamber

In the Presence Chamber the King received important guests, seated on a throne. In 1734 a delegation of Yamacraw native Americans was introduced to George II here. They presented him with a traditional tribute of eagle feathers as an emblem of peace.

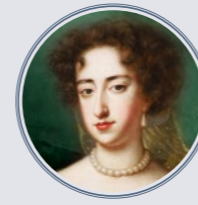

QUEEN'S STATE APARTMENTS

The Stuarts, 1690s

Step inside the oldest part of the palace. These intimate rooms were created for Queen Mary II, who ruled with her husband, King William III.

History where it happened

6 The Queen's Bedchamber

Queen Mary died in the room next to this on 28 December 1694. The much-loved queen had contracted smallpox a week earlier and had been putting her affairs in order. Her distraught husband slept in the room on a camp bed, against the advice of the doctors. She was only 32 years old when she died.



UNTOLD LIVES: A PALACE AT WORK

1680s – 1810s

Discover the stories of the overlooked people from all walks of life who worked tirelessly – often behind the scenes – to maintain, protect and promote the monarch and the royal palaces.

History where it happened

2 Origins & Identities

As a trusted servant of King George I, with intimate access to the monarch, Mehmet was an influential, and sometimes, controversial figure. Mehmet and his wife Marie Hedwig are believed to be one of the first interracial married couples at the Hanoverian Court.

Supporting exhibition partner

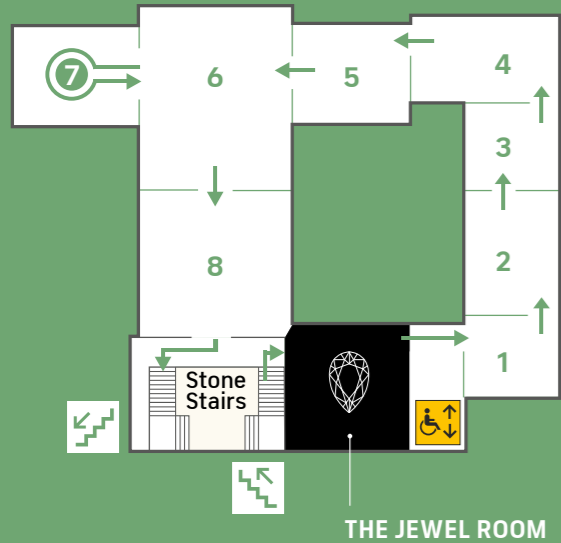

1

KEY

- 1 Young Victoria
- 2 The Princess at Play
- 3 Educating Victoria
- 4 A Royal Performance
- 5 Family Feuds
- 6 The Birthday Ball
- 7 The Baby in the Palace
- 8 Becoming Queen

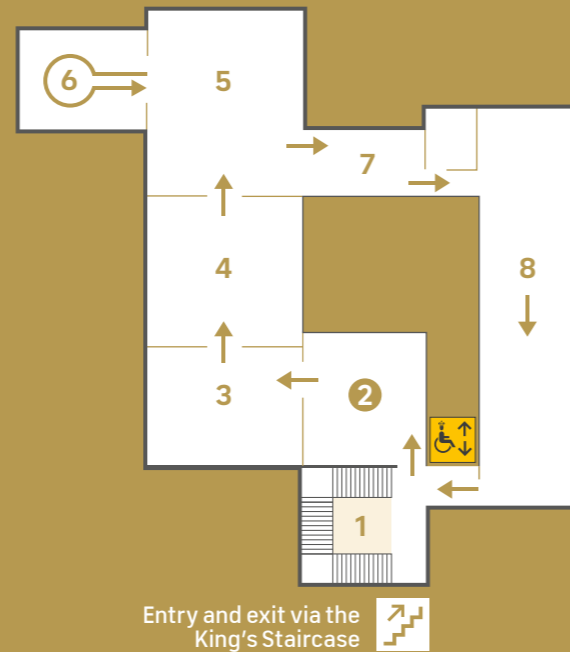

2

KEY

- 1 The King's Staircase
- 2 The Presence Chamber
- 3 The Privy Chamber
- 4 The Cupola Room
- 5 The Council Chamber
- 6 The King's Drawing Room
- 7 Queen Caroline's Closet
- 8 The King's Gallery

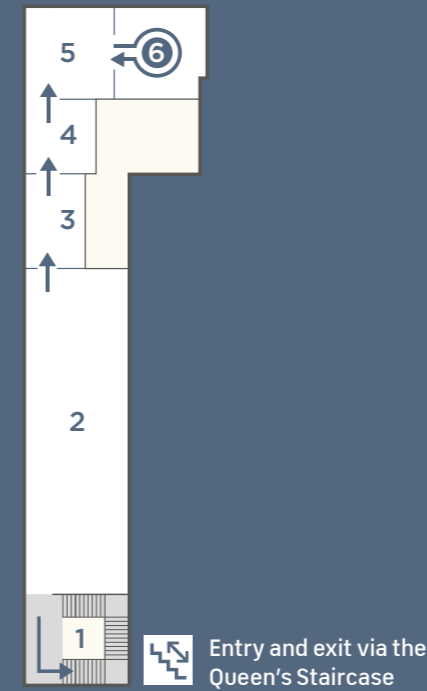

2

KEY

- 1 The Queen's Staircase
- 2 The Queen's Gallery
- 3 The Queen's Closet
- 4 The Queen's Dining Room
- 5 The Queen's Drawing Room
- 6 The Queen's Bedchamber

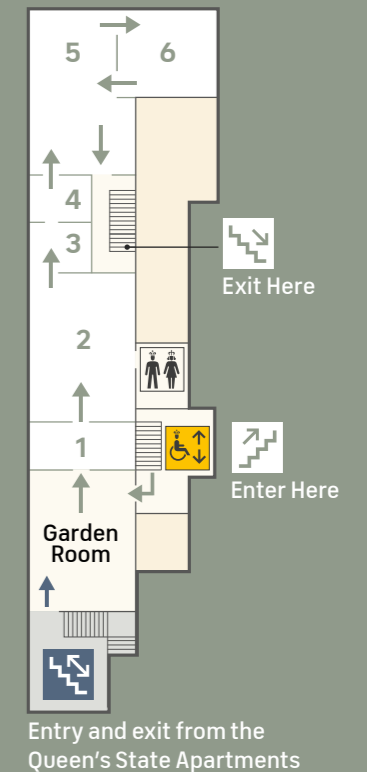

1

KEY

- 1 Introduction
- 2 Origins & Identities
- 3 Status & Hierarchy
- 4 Status & Hierarchy
- 5 Care & Intimacy
- 6 Legacies